

Plug-in Coupling Type 900 up to 25 Nm

Characteristics:

- Operational temperature of up to 500°C for short time, lasting up to 300°C
- No backlash
- High rotational speeds possible
- Maintenance free and non-wearing

Application:

For installation in

- Stepped motors
- Impulse drives
- Measuring systems
- Low output drives, etc.

TYPE 900 up to 25 Nm , mounting hub welded

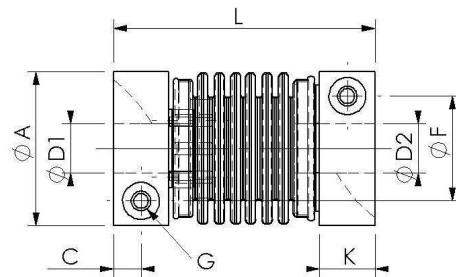

Size	M _N (Nm)	Allowed shaft misalignment in mm (lateral)	Allowed shaft misalignment in mm (axial)	Moment of inertia (ca. g cm ²)	Weight (ca. in g)	Spring constant (torque Nm/rad)	L	A	G (DIN EN ISO 4762) (Old DIN 912)	D1	D2 (plug-in Hub)	D1/D2 (Standard)	C	K	F
25	3,7	0,13	0,40	75	85	1320	42	25	M3	5...12	5...8	6H7	4,5	12	17
35.2	10	0,08	0,3	370	180	7800	48	35	M4	6...16	6...12	10H7	4,5	13,5	22
40.1	9	0,17	0,50	630	270	3350	58	40	M5	6...20	6...16	12H7	5,5	15,5	27
55.1	25	0,17	0,50	2370	660	10400	69	55	M6	14...28	14...22	16H7	7	19,5	40

Easier assembly of drives with the plug-in metal bellows couplings:

The new developed plug-in connection makes it now possible to deliver our regular metal bellows coupling as a plug-in variation. The plug-in metal bellows coupling can be used there where usual metal bellows couplings can be mounted bad or even not at all because of less or no space or there where drives have to be taken apart very often because of maintenance.

The coupling halves can be mounted to the main shaft and the output shaft and only have to fit into one another to receive a connection. With that kind of plug-in connection you can get a no backlash shaft-shaft-connection which you easily can connect and take apart. The asymmetrical arrangement of the connecting elements makes it possible that both shafts are connected synchrony again after they were taken apart and fit into one another.

We offer two new coupling types at once with this new plug-in system:

The type 900 contains smaller couplings up from an outer diameter of 25 mm which are used mainly in the measuring technique. The type 960 are bigger and stronger couplings, they can be used in tool machines, industrial robots, handling devices, textile machines or woodworking machines. At the moment variations with a nominal torsional moment up to 305 Nm at an outer diameter of 101 mm get offered as standard. Both types the bellows and hubs are welded together satisfy very high requirements. These types have the same design and dimensions as their related types (type 500 and type 560) of our delivery programme even of the plug-in connection. The plug-in types and the regular metal bellow coupling have the same compensating attributes nearly.