

Metal bellows coupling TYPE 50 - up to 25 Nm

Characteristics:

- Corrosion-resistant aluminium hubs, stainless steel metal bellows
- Operational temperature of up to 100°C (Higher temperatures please call)
- No backlash
- High rotational speeds possible
- Maintenance free and non-wearing

Application:

Predominantly used for systems with high torsional rigidity.

Available with plastic inserts for high impact resistance on request.

TYPE 50 up to 25 Nm, mounting hub glued

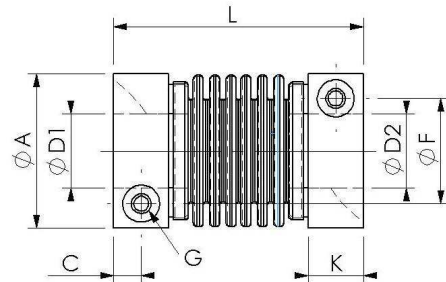
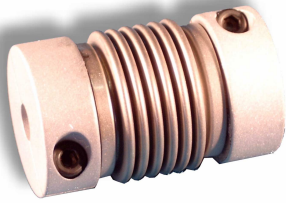

Size	M _N (Nm)	Allowed shaft misalignment in mm (lateral)	Allowed shaft misalignment in mm (axial)	Moment of inertia (app. g cm ²)	Weight (app. in g)	Spring constant (Torque Nm/rad)	L	A	G (DIN EN ISO 4762) (Old DIN 912)	D1/D2	D1/D2 (Standard)	C	K	F
16	0,7	0,10	0,30	3	10	216	26	16	M2,5	2...5	4H7	3	8	10
20	1,9	0,10	0,30	11	15	680	29	20	M2,5	3...8	6H7	3	8	13
25	3,7	0,13	0,40	35	33	1320	40	25	M3	3...12	6H7	4,5	12	17
40.1	9	0,17	0,50	297	100	3350	58	40	M5	6...20	10H7	5,5	15,5	27
40.2	14,5	0,17	0,50	309	105	5600	58	40	M5	6...20	10H7	5,5	15,5	27
55.1	25	0,17	0,50	900	240	10400	67	54	M6	14...28	16H7	7	19	40